



868 MURRAY ROAD, DOTHAN, AL 36303

"REDIFLEX" TWO-PIECE STEEL FRAME SYSTEM UTILIZING A JELD-WEN OPAQUE STEEL DOOR PANEL "IMPACT"

GENERAL NOTES

1. This product has been evaluated and is in compliance with the 7th Edition (2020) Florida Building Code (FBC) structural requirements including the "High Velocity Hurricane Zone" (HVHZ).
2. Product anchors shall be as listed and spaced as shown on details. Anchor embedment to base material shall be beyond wall dressing or stucco.
3. When used in the "HVHZ" this product complies with Section 1626 of the FBC does not require an impact resistant covering.
4. When used in areas outside of the "HVHZ" requiring wind borne debris protection this product complies with FBC Sections 1609.1.2 & R301.2.1.2 does not require an impact resistant covering. This product meets missile level "D" and includes Wind Zone 4 as defined in ASTM E 1996 and FBC Sections 1609.1.2.2 & R301.2.1.2.1.
5. For 2x stud framing construction, anchoring of these units shall be the same as that shown for 2x buck masonry construction.
6. Site conditions that deviate from the details of this drawing require further engineering analysis by a licensed engineer or registered architect.
7. Outswing configurations using high water dam threshold item #70 meet water infiltration requirements for "HVHZ".
8. Inswing configurations and outswing configurations using sill item #71 and #72 do not meet the water infiltration requirements for the "HVHZ" and shall be installed only in non-habitable areas or at habitable locations protected by an overhang or canopy such that the angle between the edge of canopy or overhang to sill is less than 45 degrees.
9. When used in the "HVHZ", all steel shall be protected as specified in Section 2222.6 of the FBC.

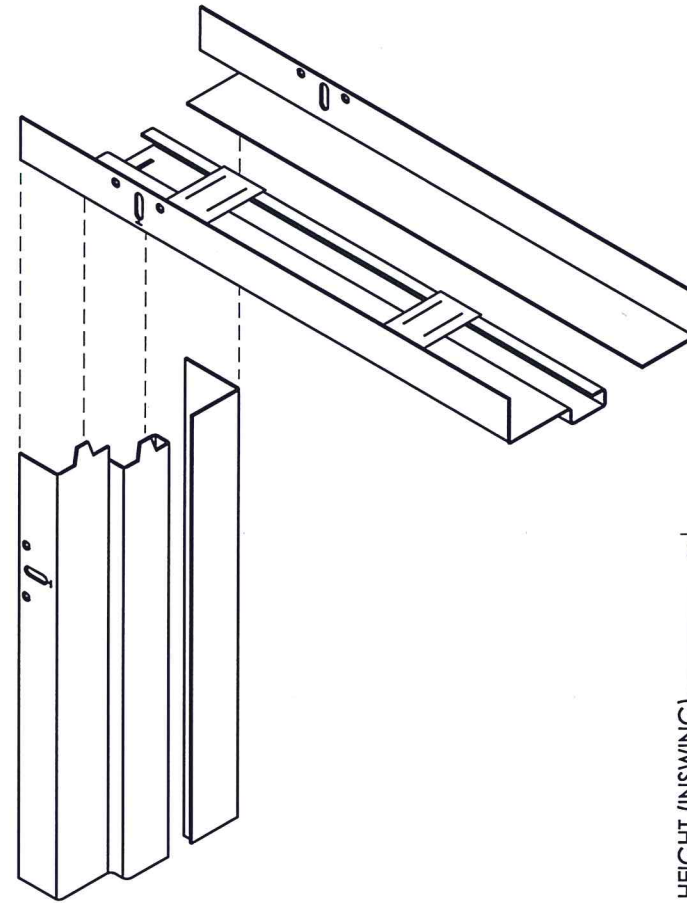

REDIFLEX TWO-PIECE

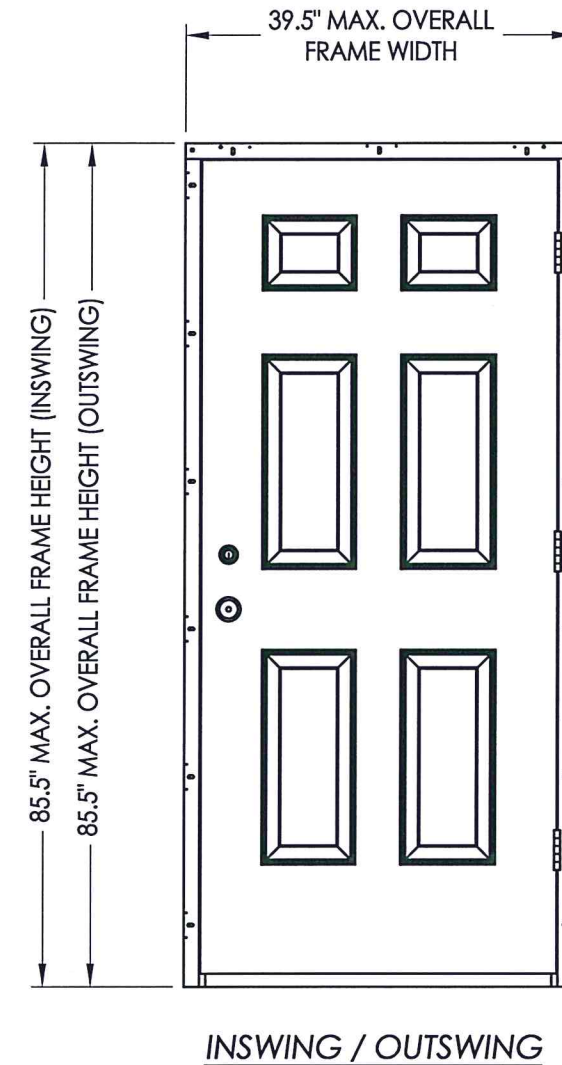

INSWING / OUTSWING

OVERALL FRAME DIMENSION	DESIGN PRESSURE (PSF)	
	POSITIVE	NEGATIVE
39.5" X 85.5"	+ 66.0	- 66.0

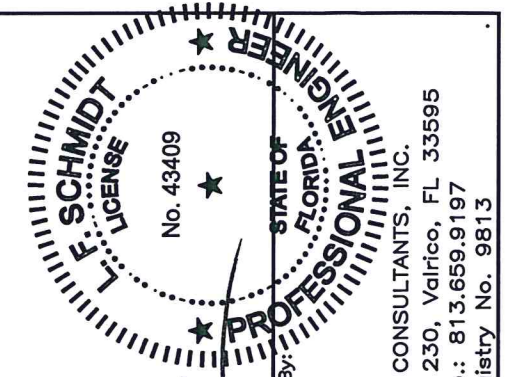

August 11, 2020
Documents Prepared By:
Lyndon F. Schmidt
P.E. No. 43409

R.W. BUILDING CONSULTANTS, INC.
P.O. Box 230, Valrico, FL 33595
Phone No.: 813.659.9197
FBPE Registry No. 9813

PRODUCT: DUNBARTON REDIFLEX TWO-PIECE STEEL FRAME		PART OR ASSEMBLY: TYPICAL ELEVATION, DESIGN PRESSURES & GENERAL NOTES	
8/11/20	UPDATE TO 7TH ED. (2020) FBC	DAC	
9/30/17	UPDATE TO 6TH ED. (2017) FBC	LFS	
1/27/16	REVISE ANCHORING	LFS	
3/23/15	UPDATE TO 5TH ED. (2014) FBC	JK	
NO.	DATE	BY	REVISIONS
DATE: 03/14/12			
SCALE: N.T.S.			
DWG. BY: JK			
CHK. BY: LFS			
DRAWING NO.: FL-15341.3			
SHEET 1 OF 8			

TABLE OF CONTENTS

SHEET #	DESCRIPTION
1	Typical elevation, design pressures & general notes
2	Steel frame cross sections & details
3	Door panel details
4	Horizontal cross sections
5	Vertical cross sections
6	Buck & frame anchoring - masonry 2x buck
7	Buck & frame anchoring - steel/2x stud
8	Bill of materials and components

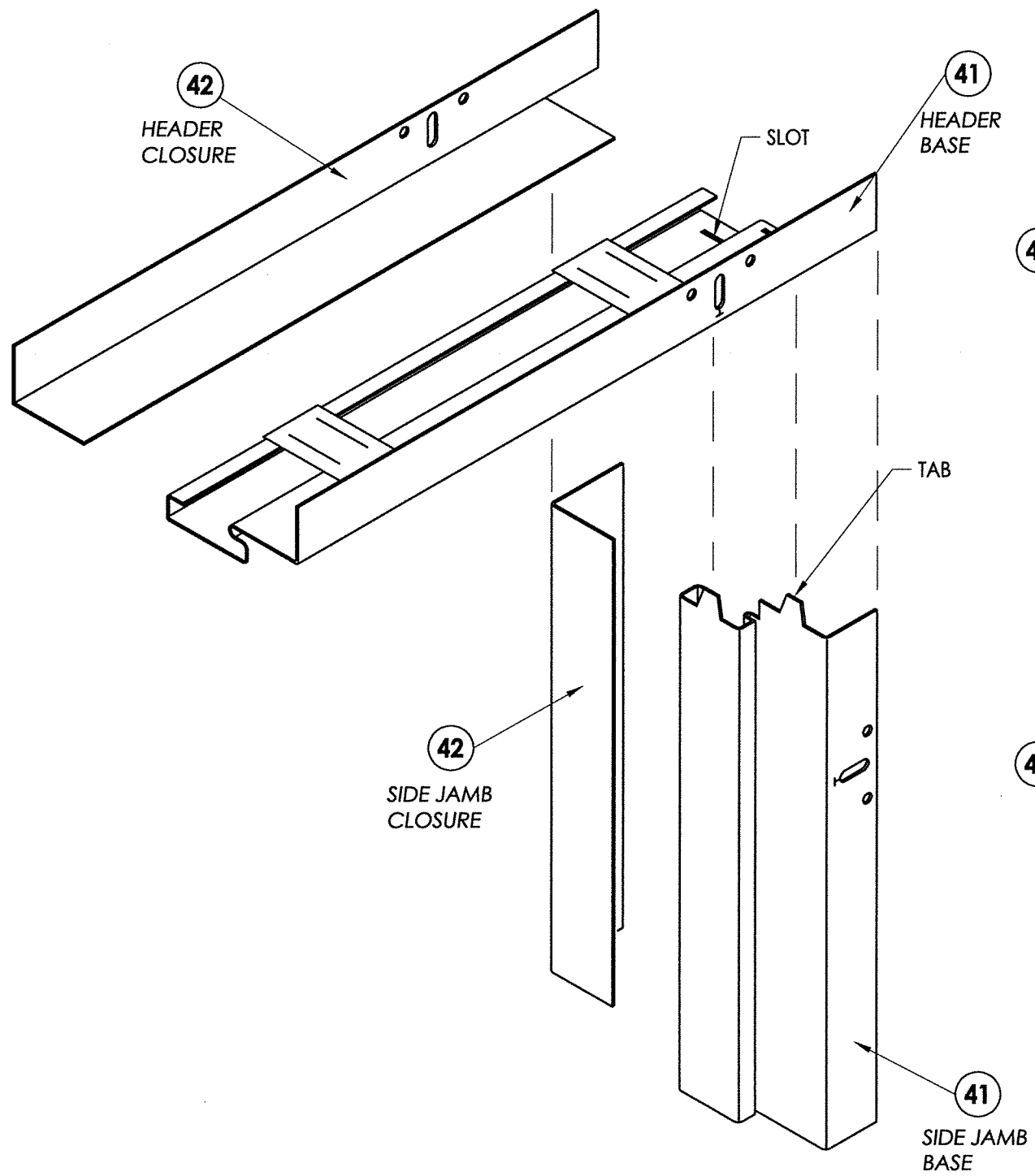

NOTES:

1. HEADER AND SIDE BASE JAMB (41) MINIMUM 18 GA. GALV. STEEL.
2. HEADER AND SIDE CLOSURE JAMB (42) MINIMUM 22 GA. GALV. STEEL.
3. FRAME SHOWN WITHOUT OPTIONAL STEEL TRIM CASING.
4. NON-KERF FRAMES DO NOT MEET AIR AND WATER CRITERIA.

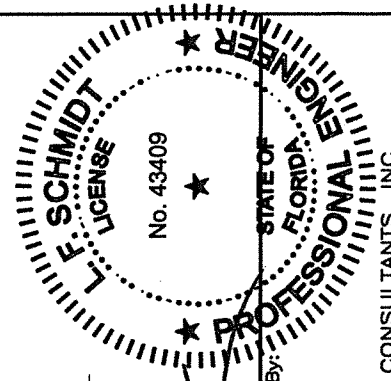
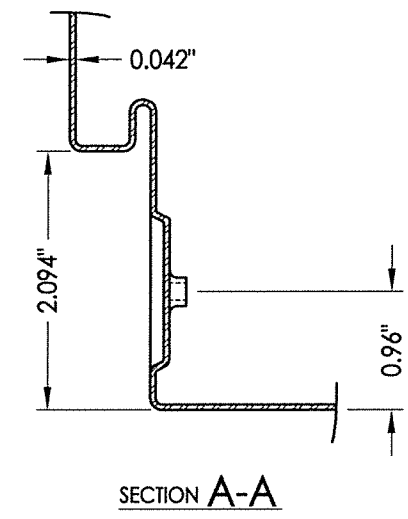
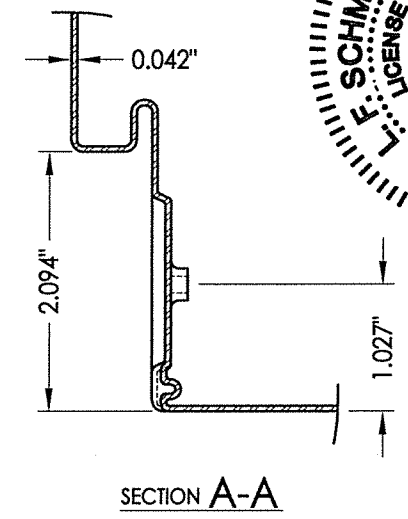
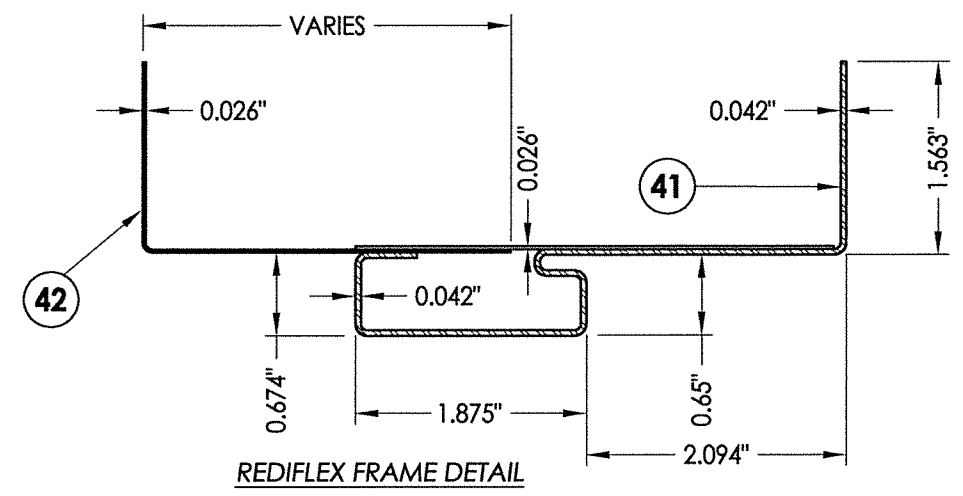
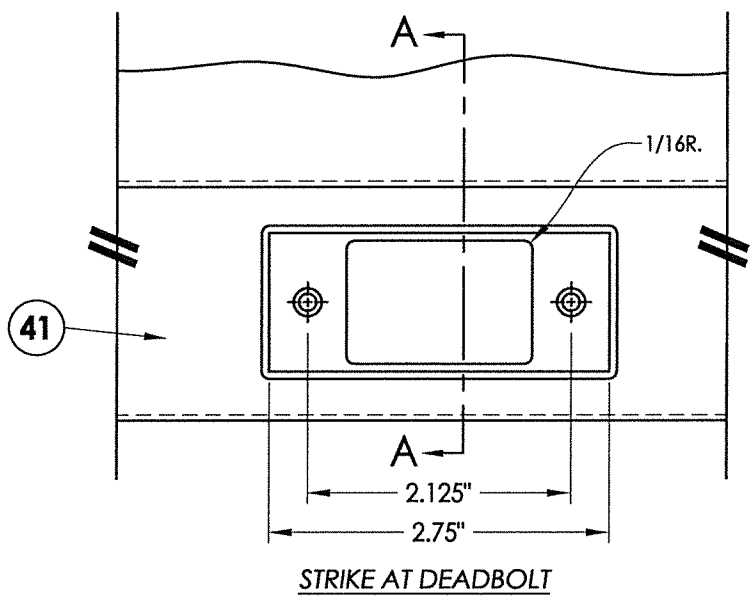
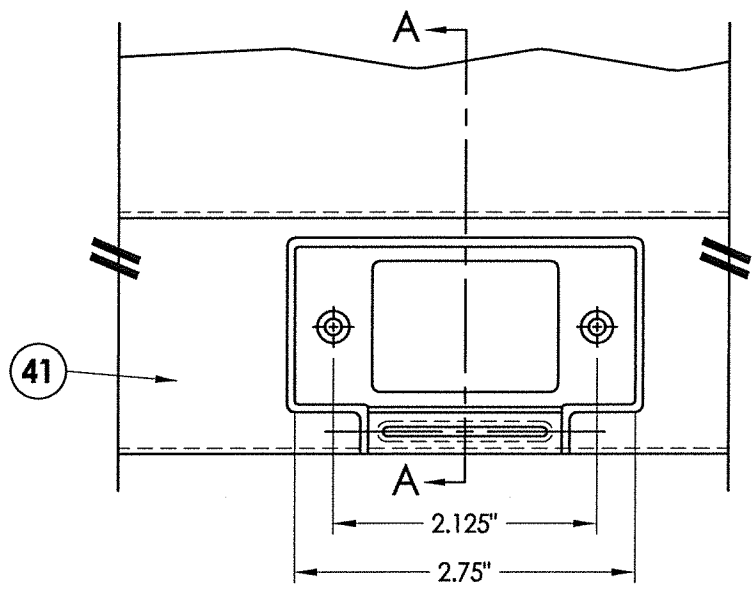

August 11, 2020
 Documents Prepared By:
 Lyndon F. Schmidt
 P.E. No. 43409
 R.W. BUILDING CONSULTANTS, INC.
 P.O. Box 230, Valrico, FL 33595
 Phone No.: 813.659.9197
 FBPE Registry No. 9813

PRODUCT:		DUNBARTON REDIFLEX TWO-PIECE STEEL FRAME	
PART OR ASSEMBLY:		STEEL FRAME CROSS SECTIONS & DETAILS	
NO.	DATE	BY	REVISIONS
4	8/11/20	DAC	UPDATE TO 7TH ED. (2020) FBC
3	9/30/17	LFS	UPDATE TO 6TH ED. (2017) FBC
2	1/27/16	LFS	REVISE ANCHORING
1	3/23/15	JK	UPDATE TO 5TH ED. (2014) FBC
DATE: 03/14/12			
SCALE: N.T.S.			
DWG. BY: JK			
CHK. BY: LFS			
DRAWING NO.: FL-15341.3			
SHEET 2 OF 8			

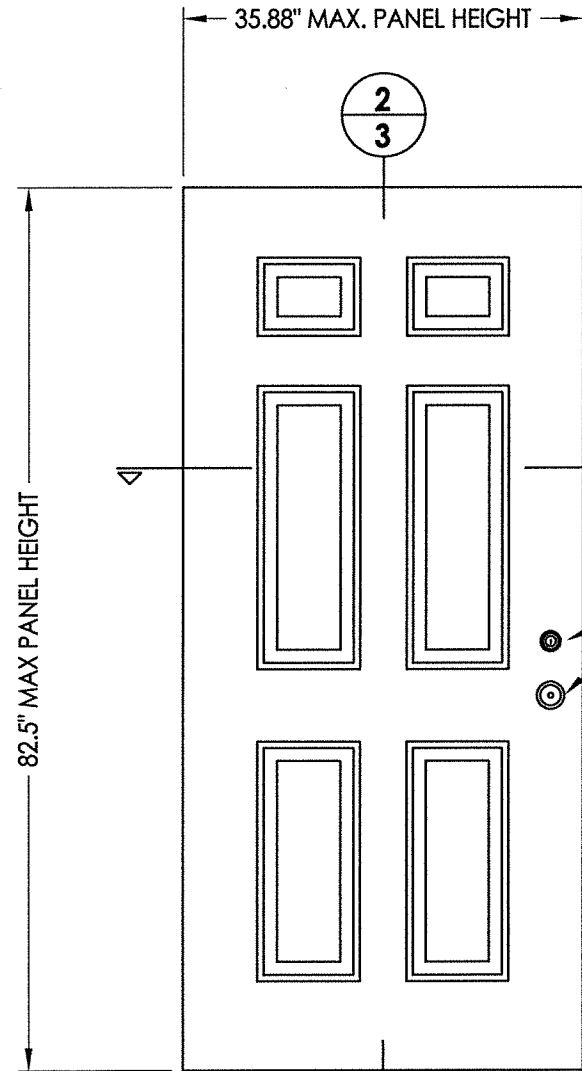

50 DOOR PANEL
JELD-WEN

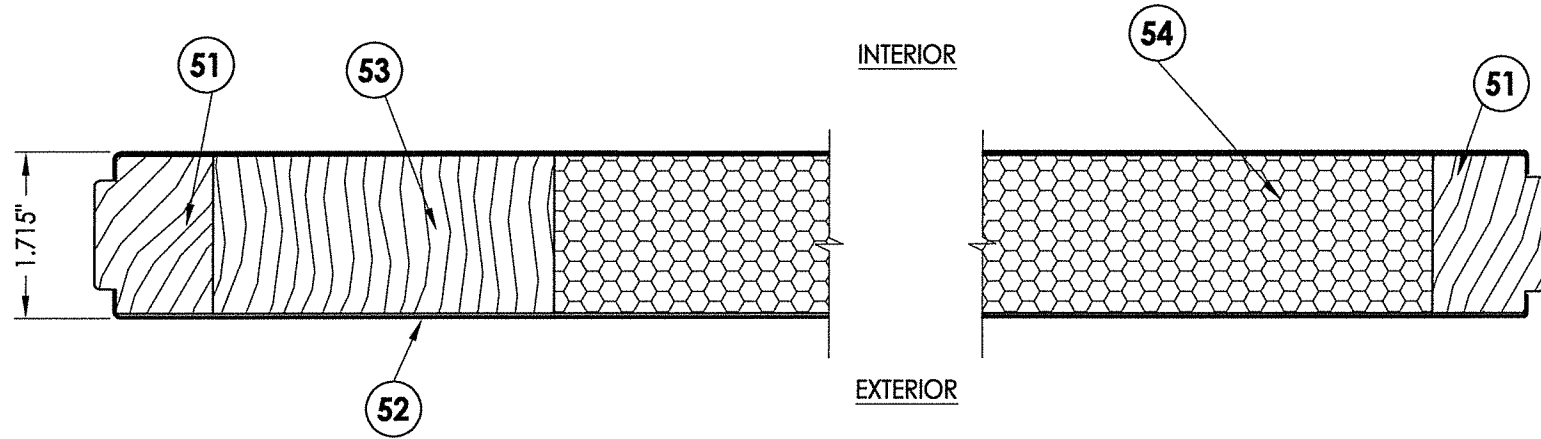

1
3 HORIZONTAL CROSS SECTION
Door panel

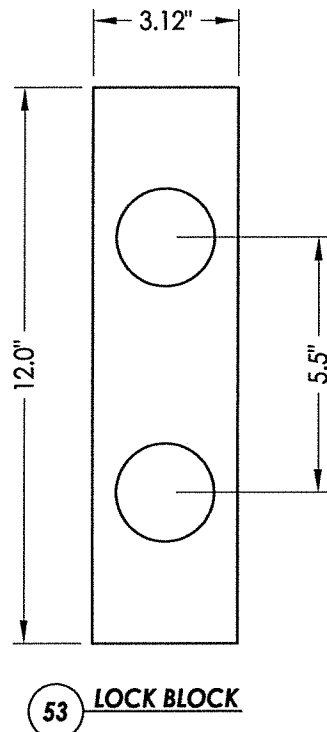

55 TOP RAIL

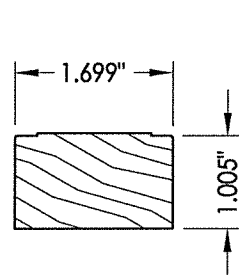

51 STILE
LATCH & HINGE

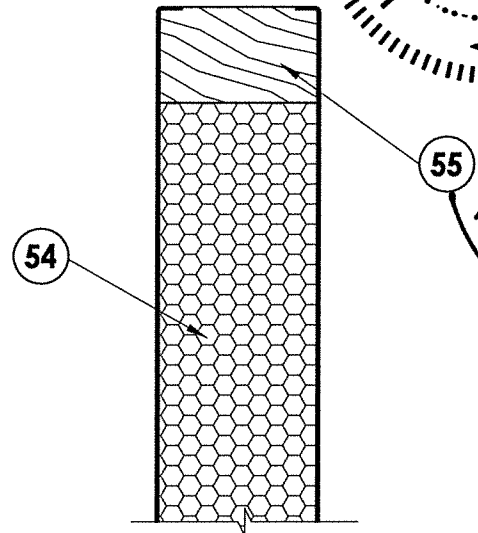
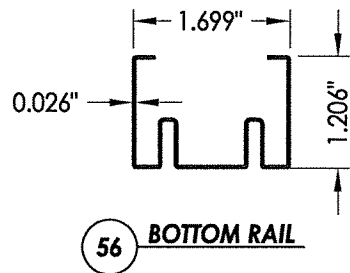
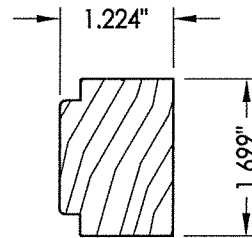

2
3 VERTICAL CROSS SECTION
Door panel

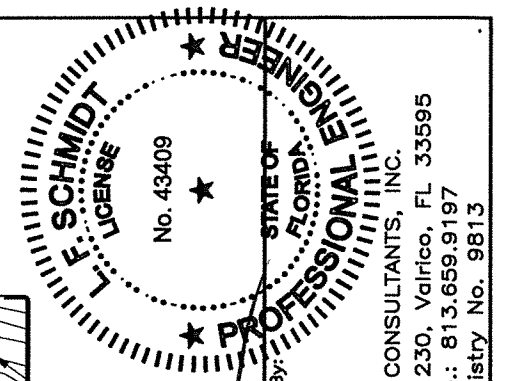

August 11, 2020
Documents Prepared By:
Lyndon F. Schmidt
P.E. No. 43409

RW BUILDING CONSULTANTS, INC.
P.O. Box 230, Valrico, FL 33595
Phone No.: 813.659.9197
FBPE Registry No. 9813

PRODUCT:
DUNBARTON REDIFLEX
TWO-PIECE STEEL FRAME

PART OR ASSEMBLY:
DOOR PANEL DETAILS

NO.	DATE	REVISIONS
4	8/11/20	UPDATE TO 7TH ED. (2020) FBC
3	9/30/17	UPDATE TO 6TH ED. (2017) FBC
2	1/27/16	REVISE ANCHORING
1	3/23/15	UPDATE TO 5TH ED. (2014) FBC
		NO. DATE

DATE: 03/14/12
SCALE: N.T.S.
DWG. BY: JK
CHK. BY: LFS
DRAWING NO.: FL-15341.3
SHEET 3 OF 8

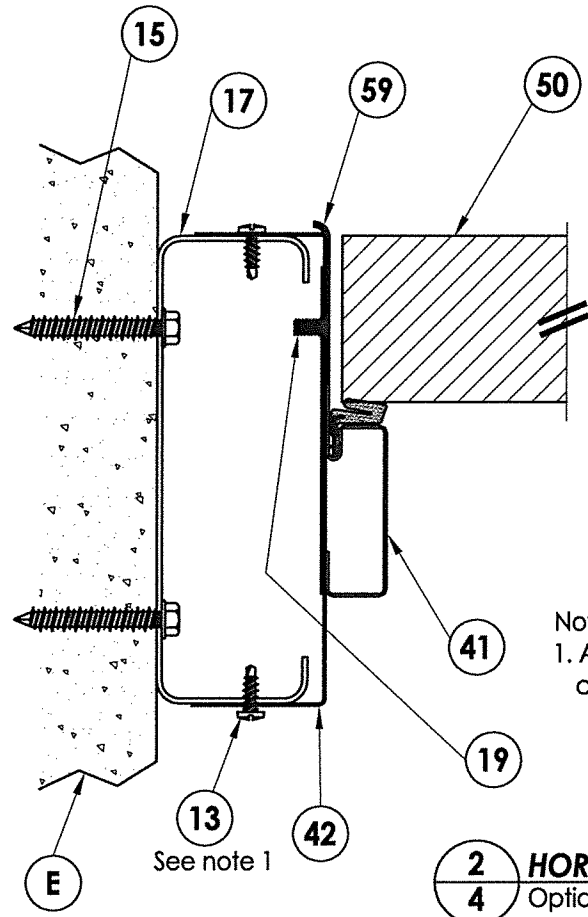
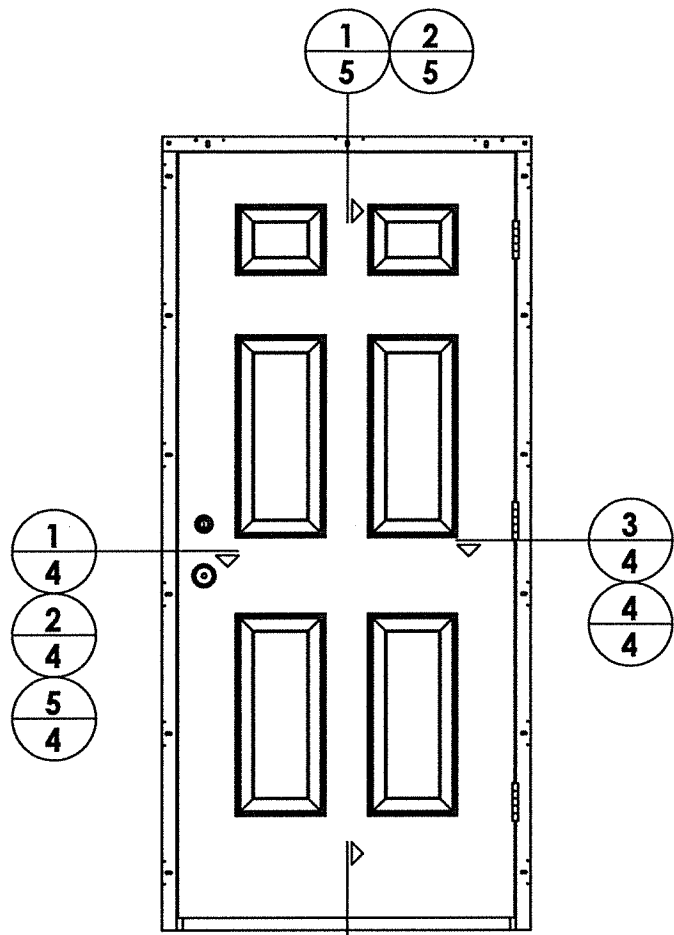

2
4 **HORIZONTAL CROSS SECTION**
Optional steel stud construction

Note:
1. A minimum of three threads must protrude completely through the supporting steel stud.

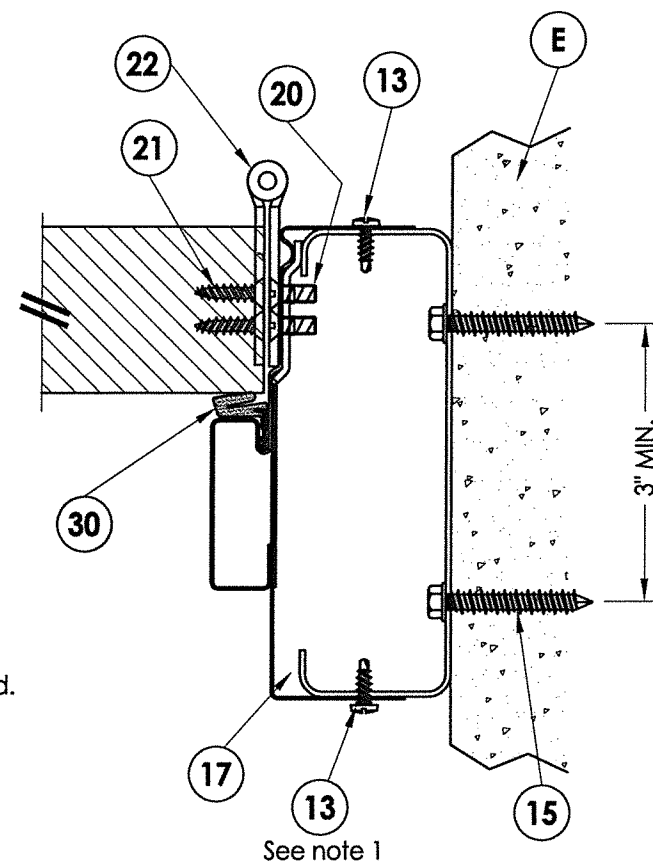

4
4 **HORIZONTAL CROSS SECTION**
Optional steel stud construction

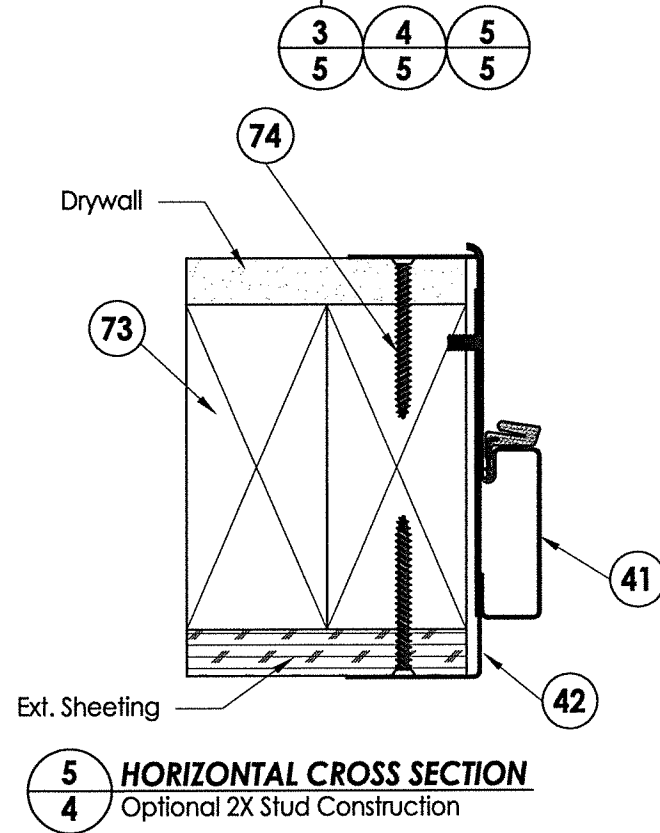

5
4 **HORIZONTAL CROSS SECTION**
Optional 2X Stud Construction

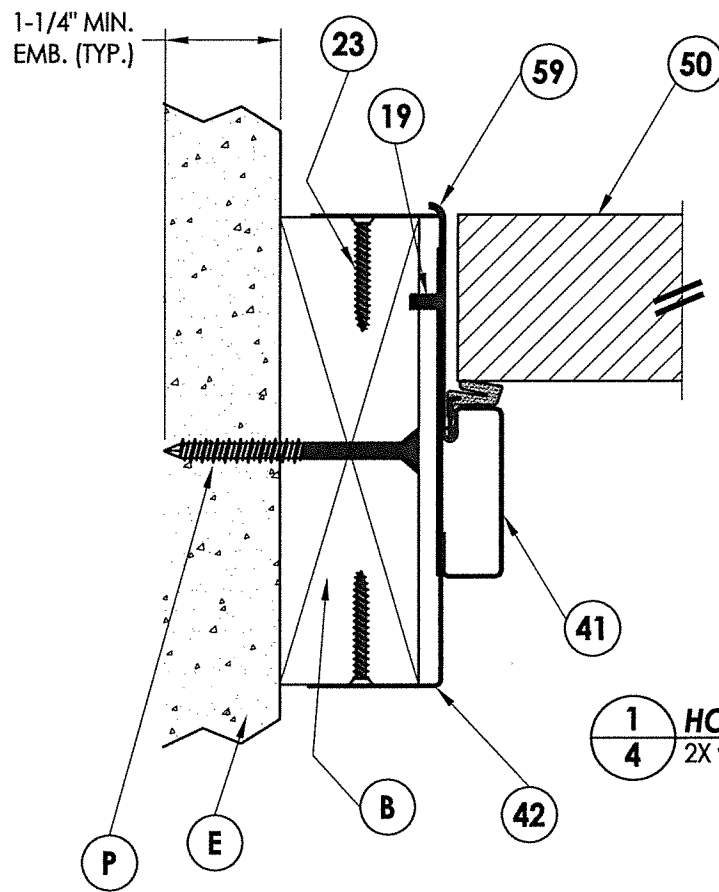

1
4 **HORIZONTAL CROSS SECTION**
2X wood buck

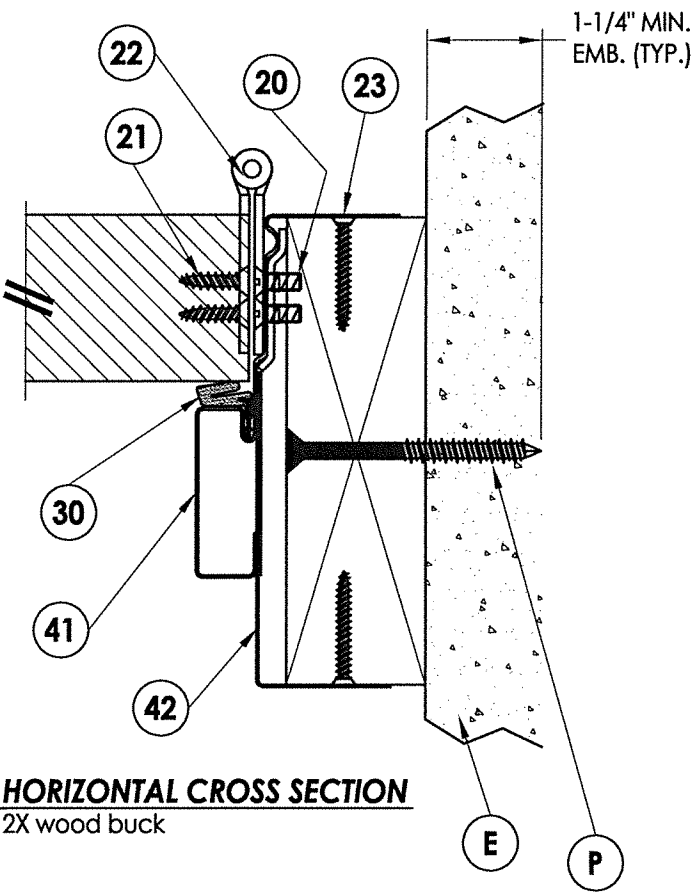

3
4 **HORIZONTAL CROSS SECTION**
2X wood buck

FLORIDA PROFESSIONAL ENGINEER
L. F. SCHMIDT
LICENSE No. 43409
STATE OF FLORIDA

August 11, 2020
Documents Prepared By: Lyndon F. Schmidt
P.E. No. 4-3409

R.W.
BUILDING CONSULTANTS, INC.
P.O. Box 230, Valrico, FL 33595
Phone No.: 813.659.9197
FBPE Registry No. 9813

PRODUCT:		DUNBARTON REDIFLEX TWO-PIECE STEEL FRAME	
PART OR ASSEMBLY:		HORIZONTAL CROSS SECTIONS	
NO.	DATE	BY	REVISIONS
4	8/11/20	DAC	UPDATE TO 7TH ED. (2020)
3	9/30/17	FBC	UPDATE TO 6TH ED. (2017)
2	1/27/16	LFS	REVISE ANCHORING
1	3/23/15	JK	UPDATE TO 5TH ED. (2014)
DATE: 3/14/12			
SCALE: N.T.S.			
DWG. BY: JK			
CHK. BY: LFS			
DRAWING NO.: FL-15341.3			
SHEET 4 OF 8			

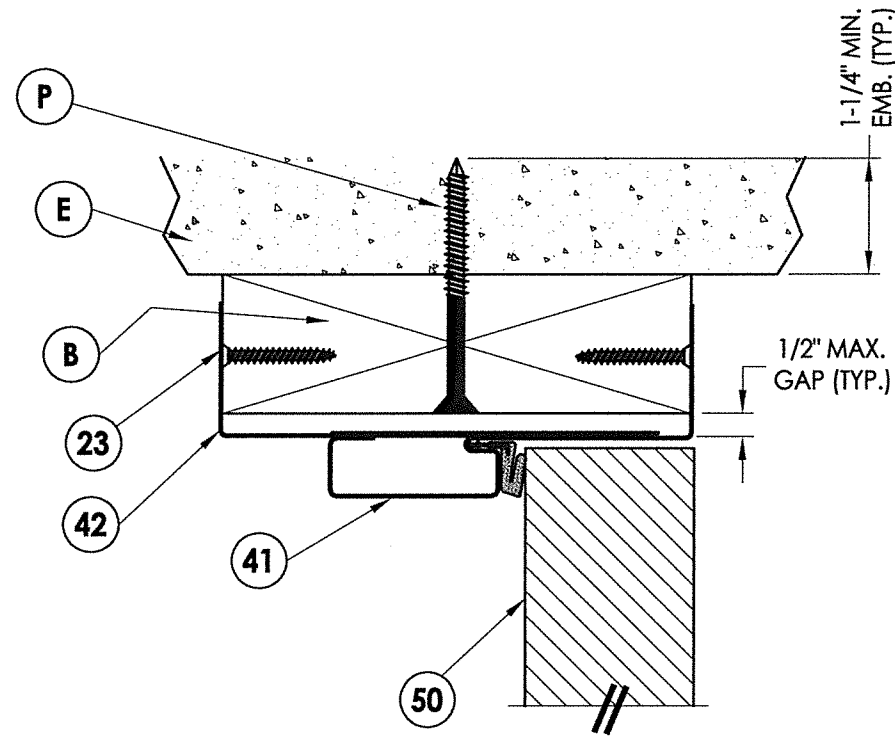

1 VERTICAL CROSS SECTION
5 2X wood buck

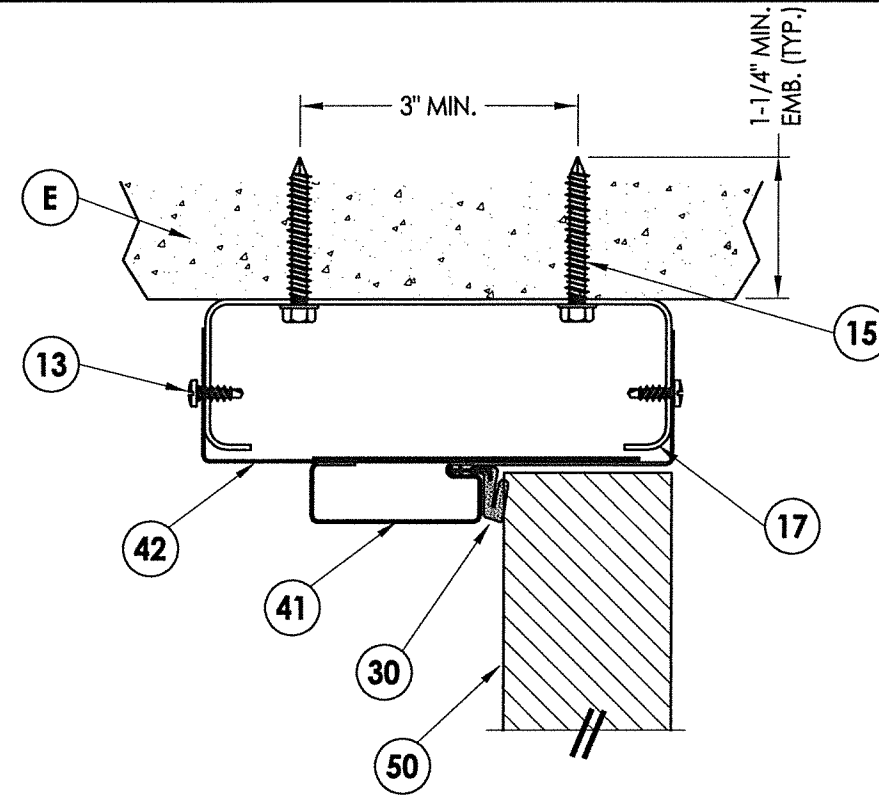

2 VERTICAL CROSS SECTION
5 Optional steel stud construction

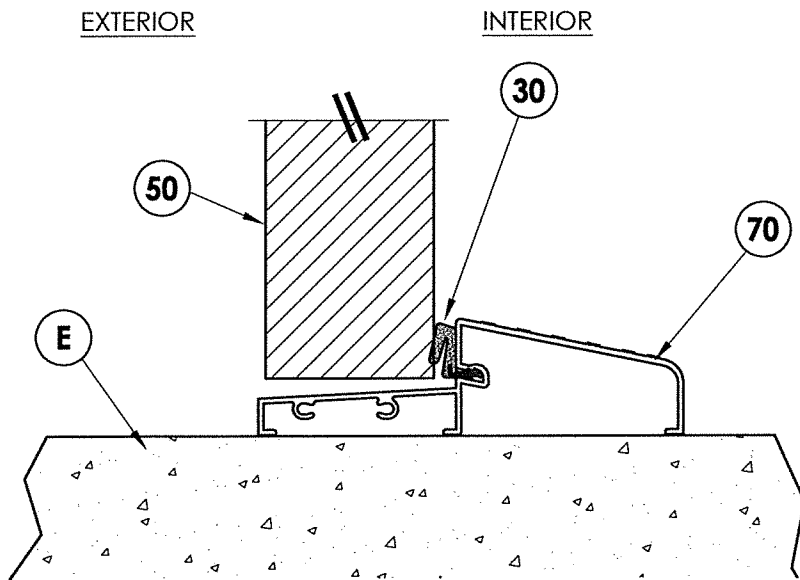

3 VERTICAL CROSS SECTION
5 Outswing configuration
see general notes, sheet 1
for "HVHZ" water infiltration
requirements

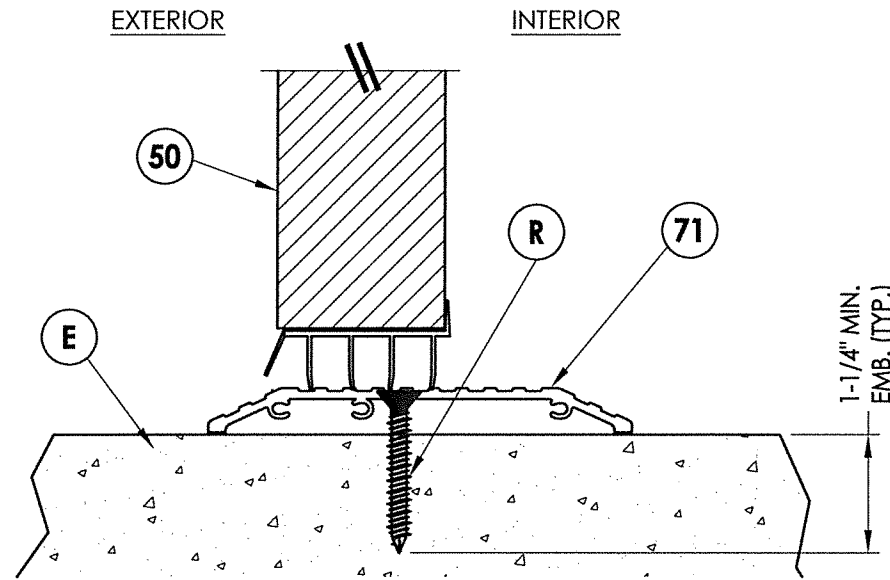

4 VERTICAL CROSS SECTION
5 Inswing configuration
see general notes, sheet 1
for "HVHZ" Water infiltration
requirements

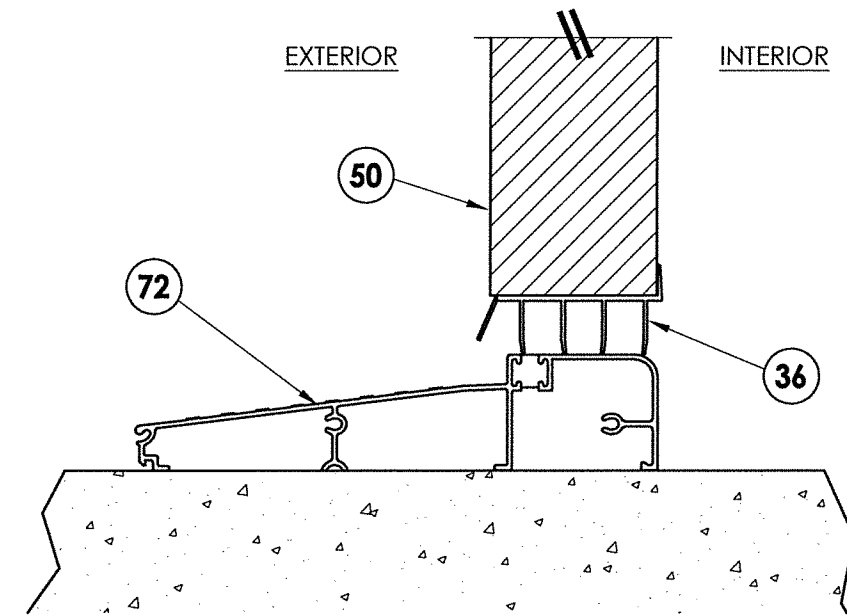

5 VERTICAL CROSS SECTION
5 Inswing configuration
see general notes, sheet 1
for "HVHZ" Water infiltration
requirements

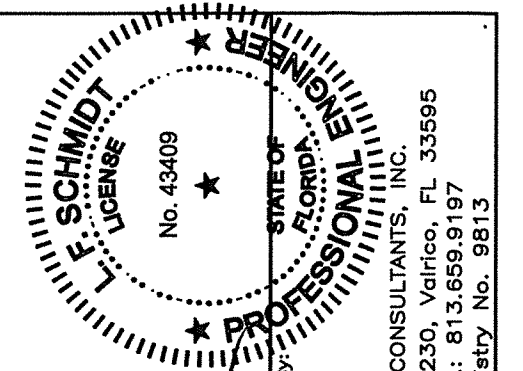

August 11, 2020
Documents Prepared By:
Lyndon F. Schmidt
P.E. No. 43409
RW
BUILDING CONSULTANTS, INC.
P.O. Box 230, Valrico, FL 33595
Phone No.: 813.659.9197
FBPE Registry No. 9813

PRODUCT:	DUNBARTON REDIFLEX TWO-PIECE STEEL FRAME	
PART OR ASSEMBLY:	VERTICAL CROSS SECTIONS	
NO.	DATE	REVISIONS
4	8/11/20	UPDATE TO 7TH ED. (2020) FBC
3	9/30/17	UPDATE TO 6TH ED. (2017) FBC
2	1/27/16	REVISE ANCHORING
1	3/23/15	UPDATE TO 5TH ED. (2014) FBC
DATE:	3/14/12	
SCALE:	N.T.S.	
DWG. BY:	JK	
CHK. BY:	LFS	
DRAWING NO.:	FL-15341.3	
SHEET	5	OF 8

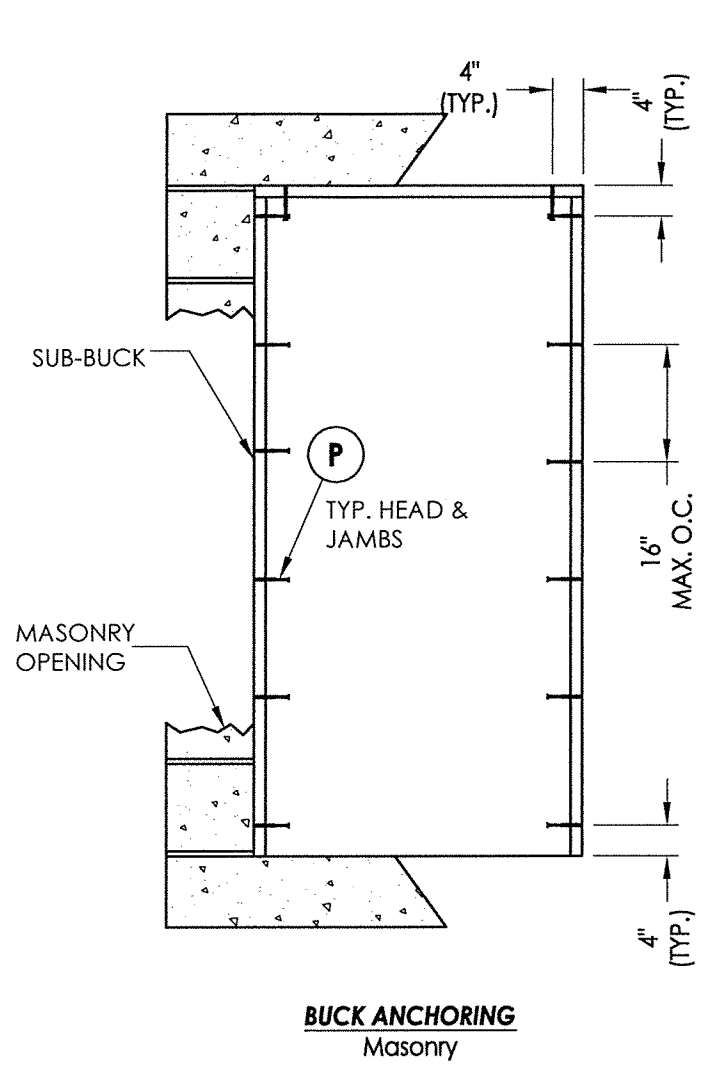

BUCK ANCHORING
Masonry

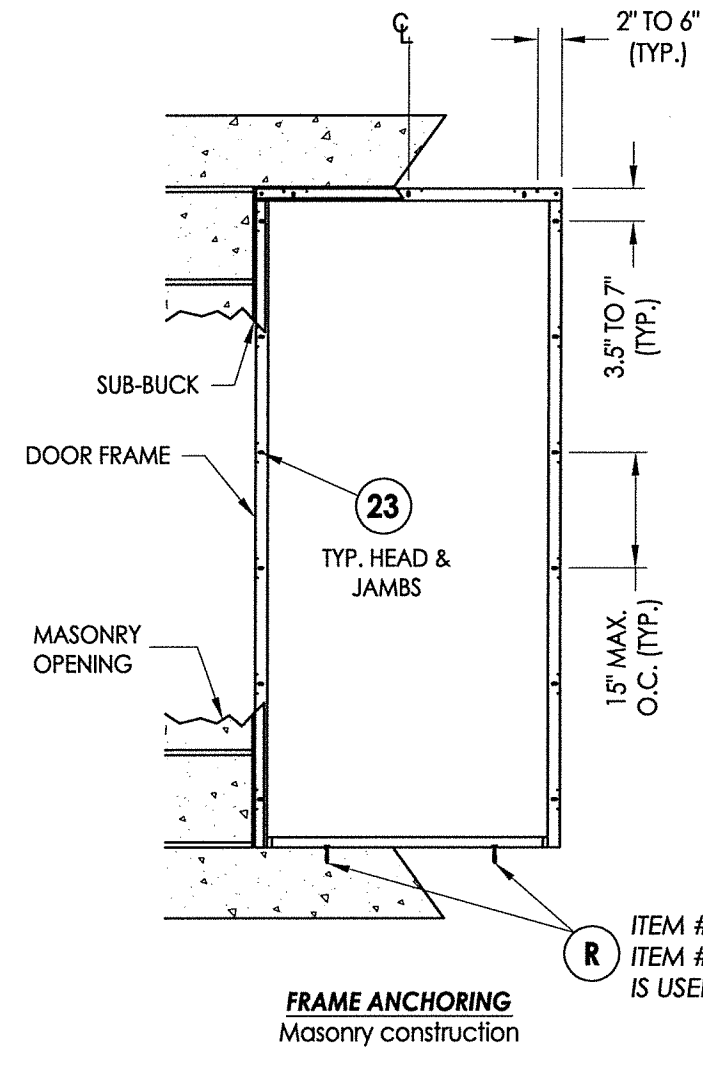

FRAME ANCHORING
Masonry construction

R ITEM #R IS USED ONLY WHEN ITEM #71, THE ADA THRESHOLD IS USED

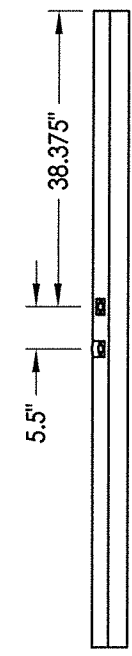

STRIKE JAMB

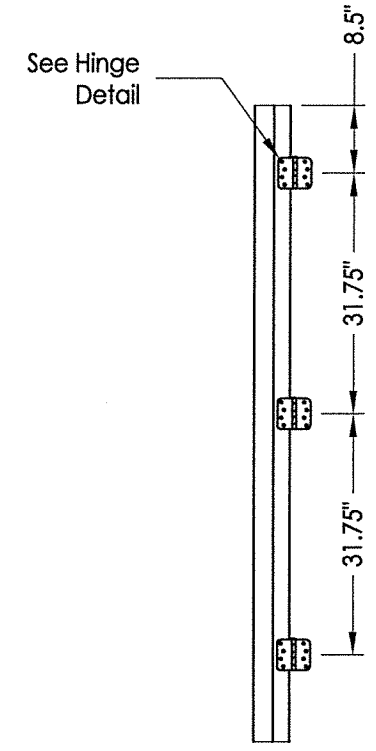

HINGE JAMB

CONCRETE ANCHOR NOTES:

- Concrete anchor locations at the corners may be adjusted to maintain the min. edge distance to mortar joints.
- Concrete anchor locations noted as "MAX. ON CENTER" must be adjusted to maintain the min. edge distance to mortar joints, additional concrete anchors may be required to ensure the "MAX. ON CENTER" dimension are not exceeded.
- Concrete anchor table:

ANCHOR TYPE	ANCHOR SIZE	MIN. EMBEDMENT	MIN. CLEARANCE TO MASONRY EDGE	MIN. CLEARANCE TO ADJACENT ANCHOR
ITW TAPCON®	1/4"	1-1/4"	2"	4"
DeWALT ULTRACON+®	1/4"	1-1/4"	1"	4"

WOOD SCREW INSTALLATION NOTES:

- Maintain a minimum 5/8" edge distance, 1" end distance, & 1" o.c. spacing of wood screws to prevent the splitting of wood.

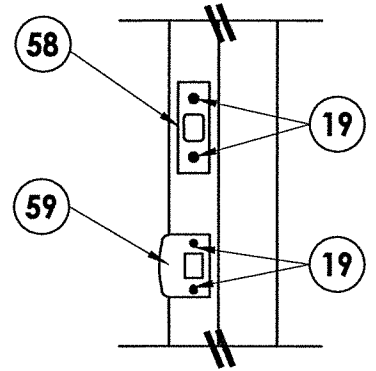

STRIKE PLATE DETAIL

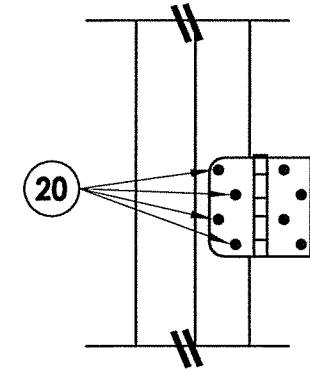

HINGE DETAIL 1

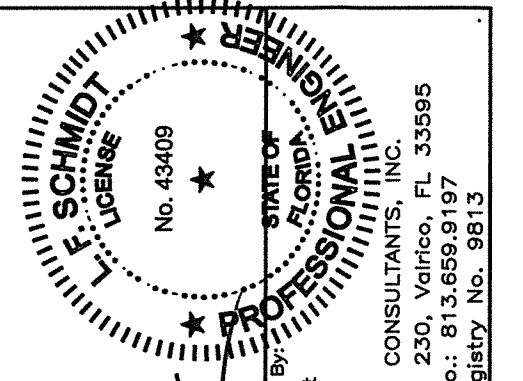

August 11, 2020
 Documents Prepared By:
 Lyndon F. Schmidt
 P.E. No. 43409
 R.W. BUILDING CONSULTANTS, INC.
 P.O. Box 230, Valrico, FL 33595
 Phone No.: 813.659.9197
 FBPE Registry No. 9813

PRODUCT:		DUNBARTON REDIFLEX TWO-PIECE STEEL FRAME	
PART OR ASSEMBLY:		BUCK AND FRAME ANCHORING MASONRY 2X BUCK	
DATE	NO.	BY	REVISIONS
8/11/20	4	DAC	UPDATE TO 7TH ED. (2020) FBC
9/30/17	3	LFS	UPDATE TO 6TH ED. (2017) FBC
1/27/16	2	LFS	REVISE ANCHORING
3/23/15	1	JK	UPDATE TO 5TH ED. (2014) FBC
03/14/12			

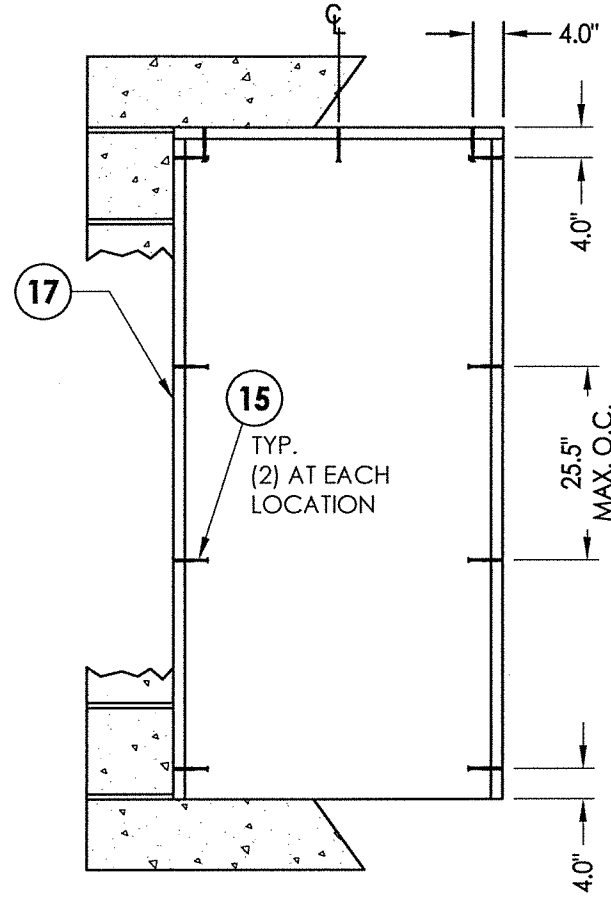

BUCK ANCHORING
Steel stud

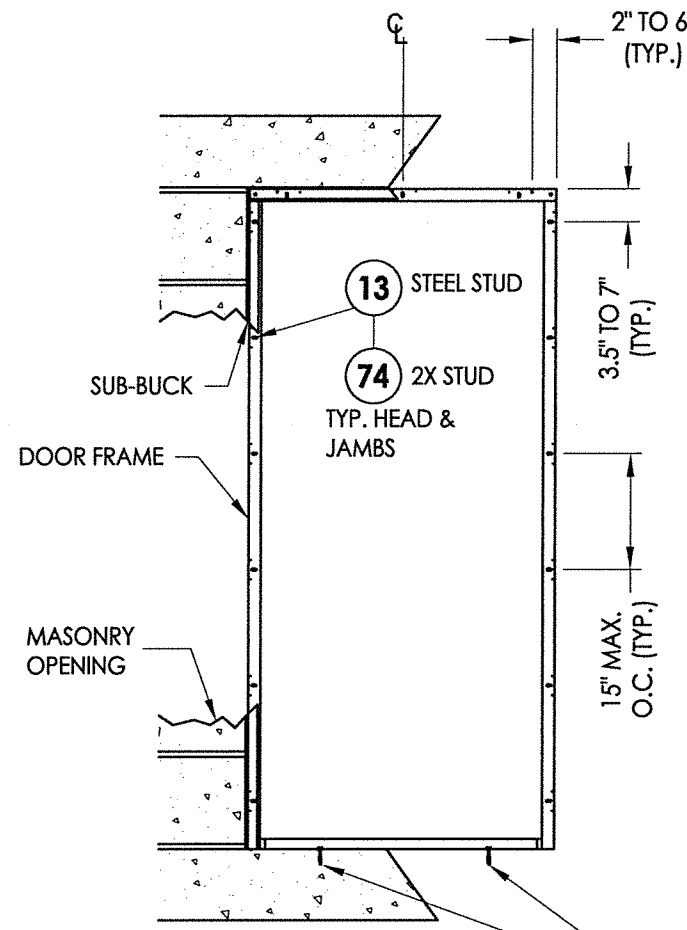

FRAME ANCHORING
Stud construction

R ITEM #R IS USED ONLY WHEN ITEM #71, THE ADA THRESHOLD IS USED

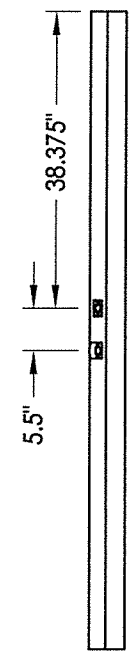

STRIKE JAMB

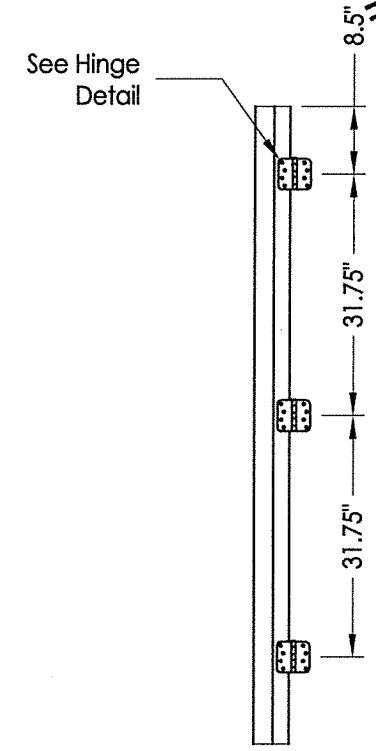

HINGE JAMB

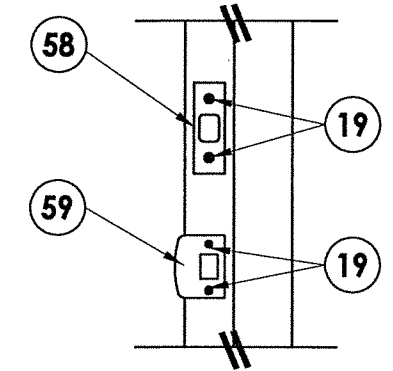

STRIKE PLATE DETAIL

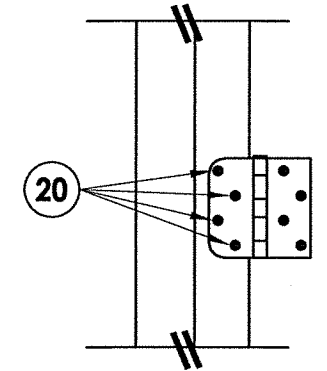

HINGE DETAIL 1

CONCRETE ANCHOR NOTES:

- Concrete anchor locations at the corners may be adjusted to maintain the min. edge distance to mortar joints.
- Concrete anchor locations noted as "MAX. ON CENTER" must be adjusted to maintain the min. edge distance to mortar joints, additional concrete anchors may be required to ensure the "MAX. ON CENTER" dimension are not exceeded.
- Concrete anchor table:

ANCHOR TYPE	ANCHOR SIZE	MIN. EMBEDMENT	MIN. CLEARANCE TO MASONRY EDGE	MIN. CLEARANCE TO ADJACENT ANCHOR
ITW TAPCON®	1/4"	1-1/4"	2"	4" / 3" (steel stud)
DeWALT ULTRACON+®	1/4"	1-1/4"	1"	4"

WOOD SCREW INSTALLATION NOTES:

- Maintain a minimum 5/8" edge distance, 1" end distance, & 1" o.c. spacing of wood screws to prevent the splitting of wood.

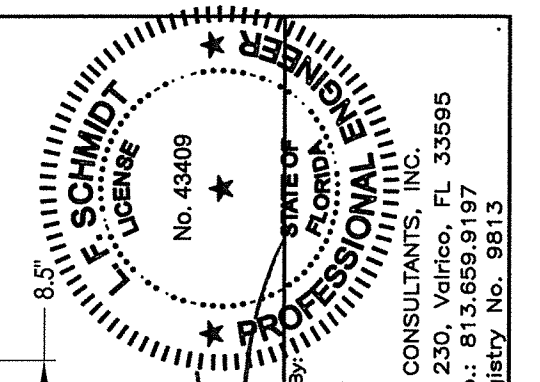

August 11, 2020
 Documents Prepared By:
 Lyndon F. Schmidt
 P.E. No. 43409
 R.W. BUILDING CONSULTANTS, INC.
 P.O. Box 230, Valrico, FL 33595
 Phone No.: 813.659.9197
 FBPE Registry No. 9813

PRODUCT:
 DUNBARTON REDIFLEX
 TWO-PIECE STEEL FRAME
 PART OR ASSEMBLY:
 BUCK & FRAME ANCHORING
 STEEL/2X STUD

NO.	DATE	REVISIONS
4	8/11/20	UPDATE TO 7TH ED. (2020) FBC DAC
3	9/30/17	UPDATE TO 6TH ED. (2017) FBC LFS
2	1/27/16	REVISE ANCHORING LFS
1	3/23/15	UPDATE TO 5TH ED. (2014) FBC JK
		BY

DATE: 03/14/12
 SCALE: N.T.S.
 DWG. BY: JK
 CHK. BY: LFS
 DRAWING NO.:
 FL-15341.3
 SHEET 7 OF 8

\\dc01\wbc\Clients\Dunbarton Permanent\A - Florida Product Approvals\FL-15341 - Exterior Door Components - Rediflex Steel Frames\C - Drawings\FL-15341 (2020)\FL-15341.1-4.dwg

BILL OF MATERIALS

ITEM	DESCRIPTION	MATERIAL
B	2X BUCK SG >= 0.55	WOOD
E	MASONRY - 3,000 PSI MIN. CONCRETE CONFORMING TO ACI 301 OR HOLLOW BLOCK CONFORMING TO ASTM C90 OR ASTM A653 STEEL	CONCRETE
P	1/4" X 2-3/4" ITW DeWALT OR ITW PFH CONCRETE SCREW	STEEL
R	1/4" X 1-3/4" ITW PFH CONCRETE SCREW	STEEL
13	#10 X 3/4" HILTI KWIK-FLEX SELF-DRILLING SCREW	STEEL
15	1/4" X 1-3/4" HWH CONCRETE SCREW	STEEL
17	SSMA STUD 550S162-54 (Fy = 33 ksi, Fu = 45 ksi)	STEEL
19	#8 x 3/8" PFH MACHINE SCREW	STEEL
20	10-24 X 1/2" FLAT HEAD SCREW	STEEL
21	#9 X 1.0" PFH WOOD SCREW	STEEL
22	4" X 4" BUTT HINGE	STEEL
23	#6 X 1-1/4" PFH WOOD SCREW (1-1/8" MIN. EMBEDMENT)	STEEL
29	JAMB HINGE REIN. 14 GA. 4" x 4" x 1.53" (.075" GALV. STEEL) BY DUNBARTON FR00505	STEEL
30	COMPRESSION WEATHERSTRIPPING QLON QDS 650 BY SCHLEGEL	FOAM
36	DOOR BOTTOM SWEEP by DUNBARTON	PVC
41	REDIFLEX JAMB BASE 18 GA. (.042" MIN. GALV. STEEL) BY DUNBARTON	STEEL
42	REDIFLEX JAMB CLOSURE 22 GA. (.026" MIN. GALV. STEEL) BY DUNBARTON	STEEL
50	STEEL DOOR PANEL - WOOD EDGE by JELD-WEN	STEEL
51	STILE - LATCH & HINGE PONDEROSA PINE	WOOD
52	STEEL SKIN (.020" THK.) (Fy = 27,500 psi min.)	STEEL
53	LOCK REINFORCEMENT BLOCK	WOOD
54	EPS CORE 1.25 LB. DENSITY	POLYSTYRENE
55	TOP RAIL - PONDEROSA PINE	WOOD
56	BOTTOM RAIL (0.026" MIN. GALVANIZED STEEL)	STEEL
58	STRIKE PLATE - DEADBOLT	STEEL
59	STRIKE PLATE - LATCHBOLT	STEEL
60	EVERSEF LATCH w/ EVERSEF DEADBOLT	STEEL
61	KWIKSET SERIES LATCH w/ KWIKSET SERIES (660) DEADBOLT	STEEL
62	SCHLAGE ULTIMA B-360 LATCH WITH SCHLAGE DEADBOLT	STEEL
70	OUTSWING BUMP THRESHOLD by ENDURA	ALUM
71	ADA THRESHOLD by ENDURA	ALUM
72	INSWING FIXED THRESHOLD BY ENDURA	ALUM
73	2X FRAMING: SG >= 0.42	WOOD
74	#8 x 1-3/4" PFH SMS (1-1/8" MIN. EMBEDMENT)	STEEL

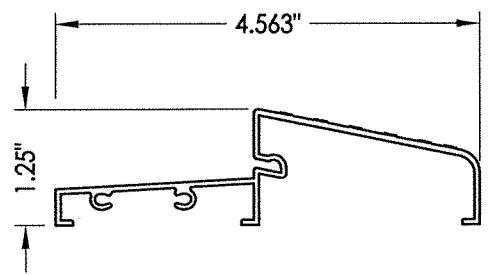

70 OUTSWING THRESHOLD

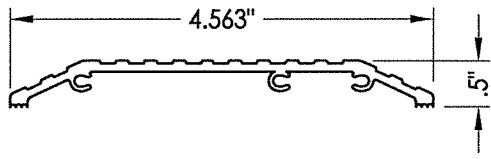

71 ADA SILL

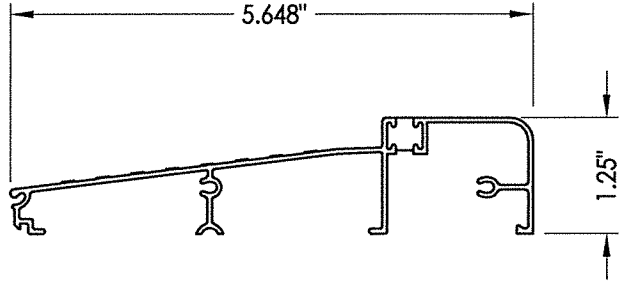

72 INSWING ALUMINUM THRESHOLD

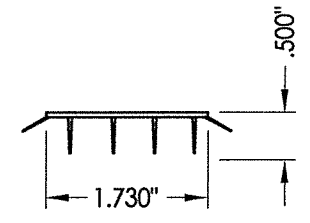

36 FIN TYPE SWEEP

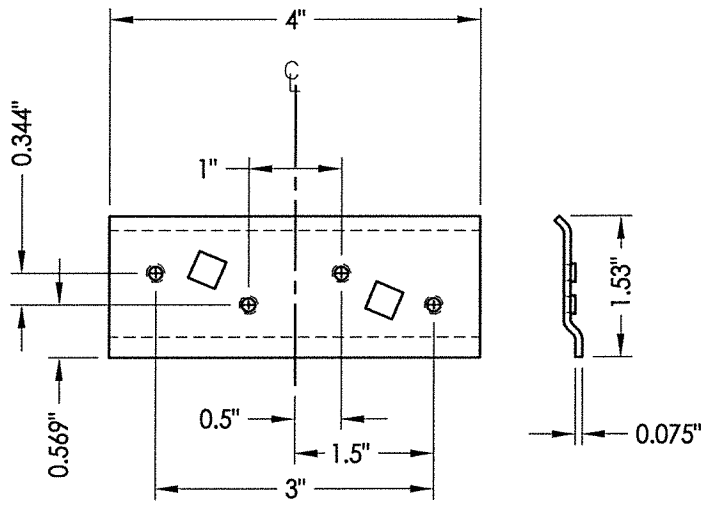

29 HINGE REINFORCEMENT

FLORIDA PROFESSIONAL ENGINEER
 No. 43409
 STATE OF FLORIDA

August 11, 2020
 Documents Prepared By: Lyndon F. Schmidt
 P.E. No. 43409

R.W. BUILDING CONSULTANTS, INC.
 P.O. Box 230, Valrico, FL 33595
 Phone No.: 813.659.9197
 FBPE Registry No. 9813

PRODUCT:		DUNBARTON REDIFLEX TWO-PIECE STEEL FRAME	
PART OR ASSEMBLY:		BILL OF MATERIAL & COMPONENTS	
NO.	DATE	BY	REVISIONS
4	8/11/20	JK	UPDATE TO 7TH ED. (2020)
3	9/30/17	LFS	UPDATE TO 6TH ED. (2017)
2	1/27/16	LFS	REVISE ANCHORING
1	3/23/15	JK	UPDATE TO 5TH ED. (2014)
DATE: 03/14/12			
SCALE: N.T.S.			
DWG. BY: JK			
CHK. BY: LFS			
DRAWING NO.: FL-15341.3			
SHEET 8 OF 8			

© 2012 R.W. BUILDING CONSULTANTS INC.